

NESPA ENTERPRISES INC.

2800 Richter Ave. Suite E
 Oroville, CA 95966
 Office: (888) 479-4677 Fax: (530) 534-9915
 E-Mail: nespa@pacbell.net www.tiledspas.com

CUSTOM

SPA DETAIL



SCALE: 1/2" = 1'-0"

DATE: 4/30/02

JOB: TOOT/BRESNAHAN

DR#: TBR-SD1

ALL DIMENSIONS SUBJECT TO 1/4" TOLERANCES

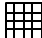
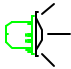
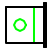
SKID SUPPORT STRUCTURE BONDED TO SPA  
MAIN DRAIN  9" X 9"
LOW VOLTAGE LIGHT 
JACUZZI SV FRONT ACCESS SKIMMER 

SPECIFICATIONS
DRY WEIGHT: 1500 lbs.
WET WEIGHT: 13075 lbs.
WATER: 1390 GALLONS
SURFACE AREA: 75 sq.ft.
IAPMO#: 1138
FDA#: 2030305
SPECS BASED ON FULL TUB

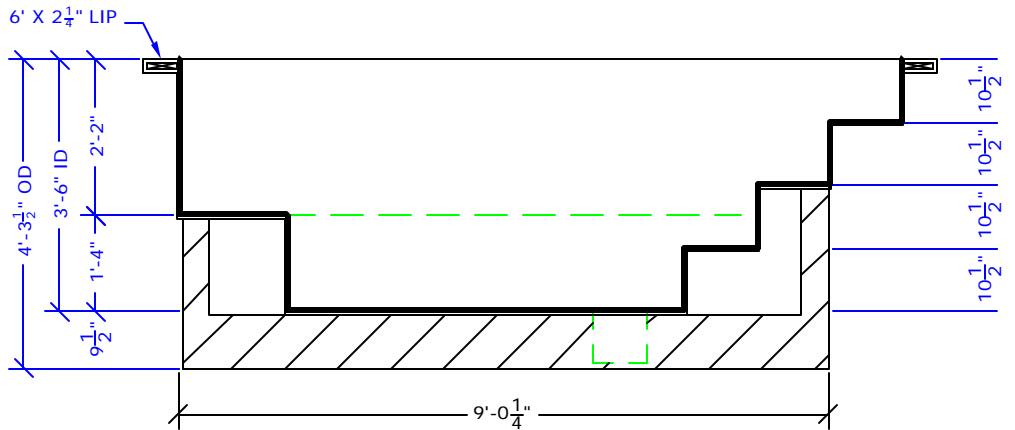
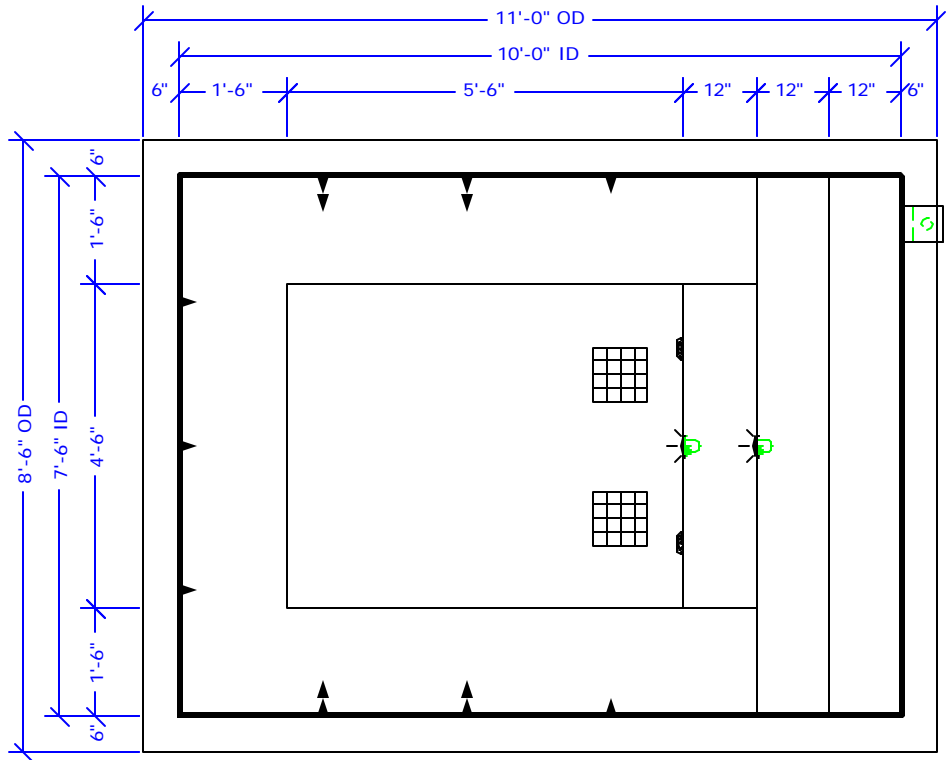

NESPA ENTERPRISES INC.

2800 Richter Ave. Suite E

Oroville, CA 95966

Office: (888) 479-4677 Fax: (530) 534-9915

E-Mail: nespa@pacbell.net www.tiledspas.com

CUSTOM

TILE LAYOUT

ALL DIMENSIONS SUBJECT TO 1/4" TOLERANCES

SCALE: 1/2" = 1'-0"

DATE: 4/29/02

JOB: TOOT/BRESNAHAN

DR#: TBR-TL1

PORTOBELLO FERRARA GOLD 3"X12" BULLNOSE

NOBLE #55-668 BLUE CHINA 6"X6"

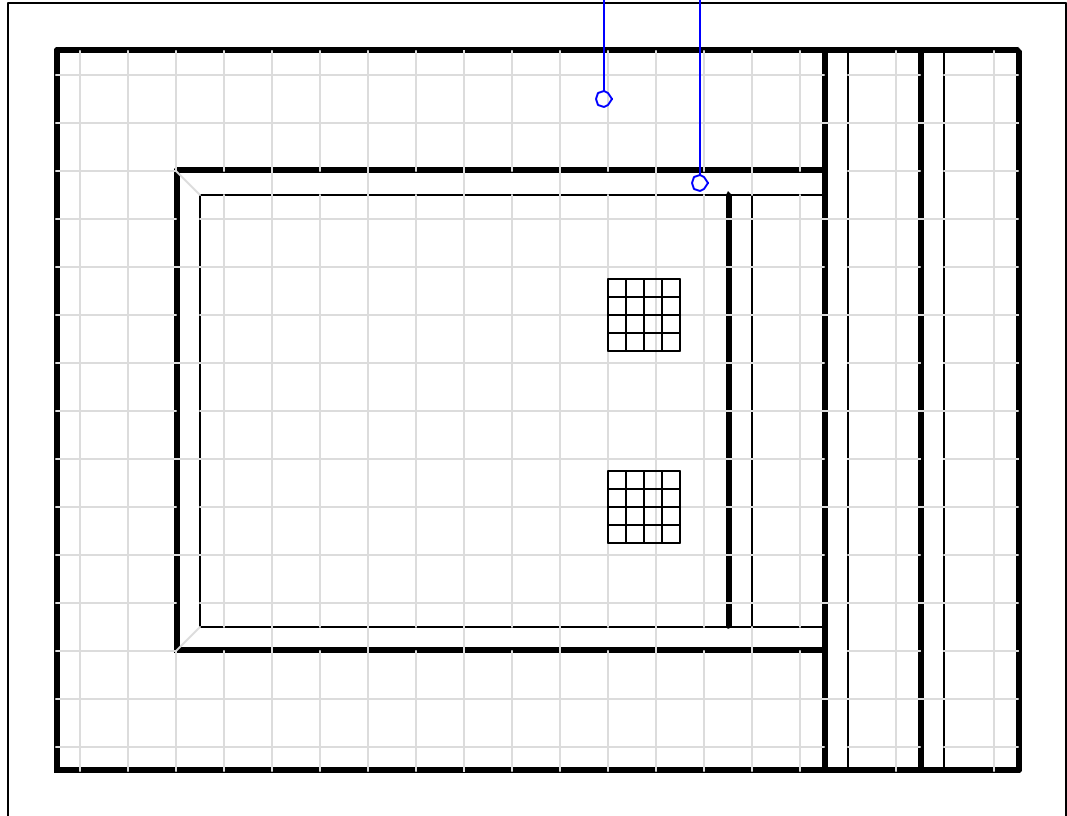

NOBLE #55-668 BLUE CHINA 6"X6"

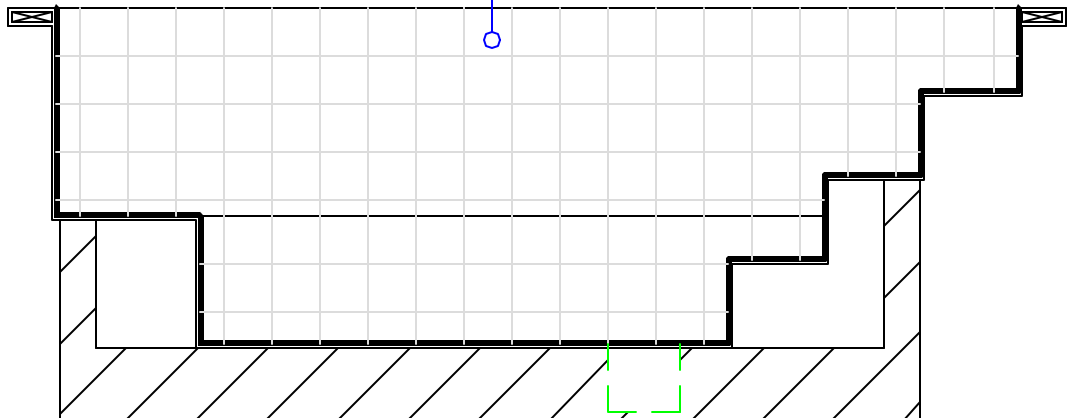

NESPA ENTERPRISES INC.

2800 Richter Ave. Suite E

Oroville, CA 95966

Office: (888) 479-4677 Fax: (530) 534-9915

E-Mail: nespa@pacbell.net www.tiledspas.com

CUSTOM

JET LOCATION

ALL DIMENSIONS SUBJECT TO 1/4" TOLERANCES

SCALE: 1/2" = 1'-0"

DATE: 4/30/02

JOB: TOOT/BRESNAHAN

DR#: TBR-JL1

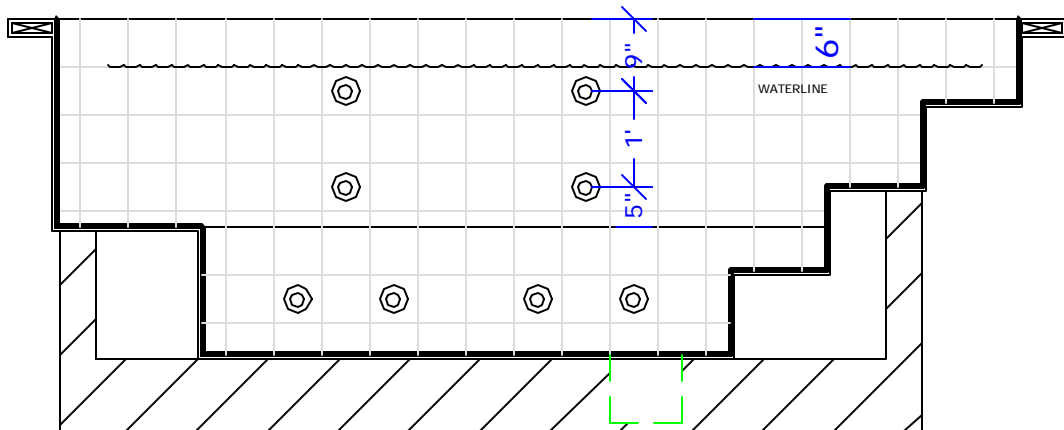
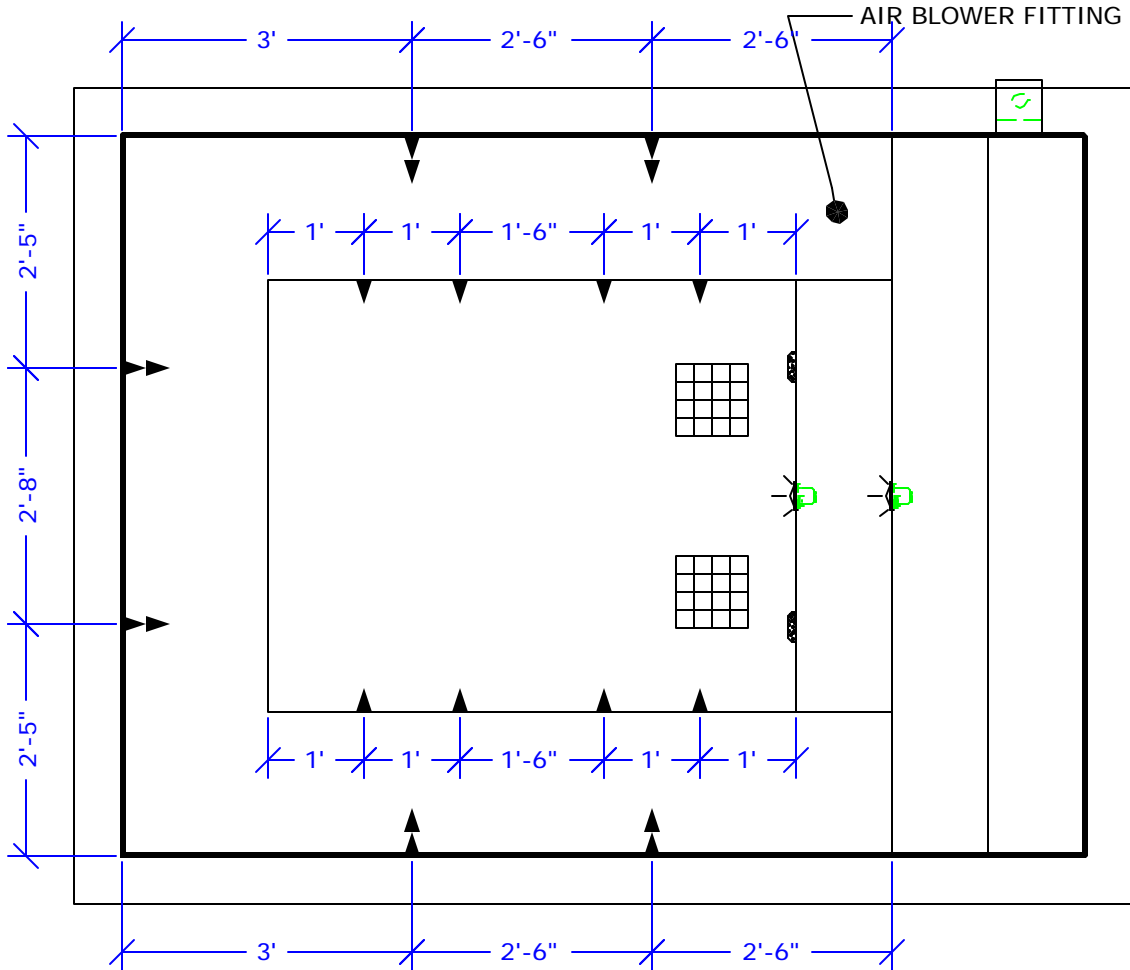

NESPA ENTERPRISES INC.

2800 Richter Ave. Suite E
Oroville, CA 95966

Office: (888) 479-4677 Fax: (530) 534-9915
E-Mail: nespa@pacbell.net www.tiledspas.com

CUSTOM

PLUMBING DETAIL

ALL DIMENSIONS SUBJECT TO 1/4" TOLERANCES

SCALE: 3/8" = 1'-0"

DATE: 4/30/02

JOB: TOOT/BRESNAHAN

DR#: TBR-PD1

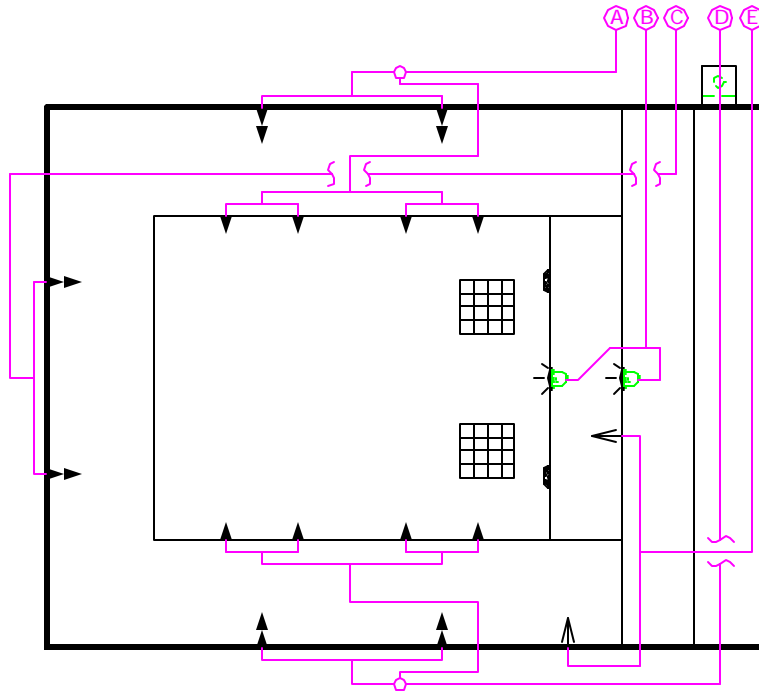

PIPES	
A	3" BOOSTER RETURN
B	1" LIGHT CONDUIT
C	3" BOOSTER RETURN
D	3" BOOSTER RETURN
E	2 FILTER RETURN
F	3" BOOSTER SUCTION
G	3" FILTER SUCTION
H	3" BOOSTER SUCTION
I	3" BOOSTER SUCTION
J	2" SKIMMER LINE

